

## Glass Pyramids



*The Twinfix range of high quality rooflights are designed to provide the maximum efficient distribution of natural light, together with a variety of ventilation options.*

- Building Regulation Part L compliant design to achieve low U value targets
- Non Fragile in accordance with ACR[M]001:2005 and CWCT TN67
- Ventilation options for Natural Ventilation are available in larger sized rooflights

Twinfix self-supporting Pyramids are designed to be installed to a weathered builder's kerb. All Pyramids are purpose made to suit variable overall kerb sizes, within a span range from 0.6m to 7m.

### **Glazing Bar Configuration**

Up to 1.5m span – Hip Rafters only

1.5m to 2m span – Centre glazing bar

Over 2m span – Jack Rafters are required

Twinfix Pyramids are manufactured from mill finish or polyester powder coated aluminium extrusions and are glazed with hermetically sealed argon filled double glazed units as standard.

### Standard Glazing Options

| Glazing   | Glazing Options | U-Value                | Light Transmission | G-Value |
|---|-----------------|------------------------|--------------------|---------|
| Outer: 4mm Toughened<br>Cavity: 16mm Argon<br>Inner: 6.4mm Laminated<br>with soft Low-E coating | Clear           | 1.2 W/m <sup>2</sup> K | 79%                | 0.70    |
|   | Self-Cleaning   | 1.2 W/m <sup>2</sup> K | 76%                | 0.67    |
|   | Tinted Bronze   | 1.2 W/m <sup>2</sup> K | 53%                | 0.51    |
| Outer: 6mm Toughened<br>Cavity: 16mm Argon<br>Inner: 6.4mm Laminated<br>with soft Low-E coating | Clear           | 1.2 W/m <sup>2</sup> K | 78%                | 0.68    |
|   | Solar Control   | 1.1 W/m <sup>2</sup> K | 67%                | 0.41    |
|   | Self-Cleaning   | 1.2 W/m <sup>2</sup> K | 76%                | 0.65    |
|   | Tinted Bronze   | 1.2 W/m <sup>2</sup> K | 43%                | 0.42    |
| Other glazing options or specification are available on request                                 |                 |                        |                    |         |

### British Standards

Twinfix Pyramids are designed to standard loadings of 640 N/m<sup>2</sup> (wind) and 750 N/m<sup>2</sup> (snow) and in accordance with the following British Standards:

- BS 6375 : Part 1 : Weather Tightness
- BS EN 1026 : Air Permeability
- BS EN 1027 : Water Tightness Test
- BS EN 12211 : Wind Resistance Test

### Pitch Options

Standard pitch angle is 30°.

Other pitch angles from 15° to 60° can be accommodated by bespoke design.

**Standard 30° Pyramids with stepped edge glazing detail** are available for an overall kerb span range from 600mm to 3000mm.

**Bespoke variable pitch Pyramids** are available for an overall span range of 600mm to 7000mm. Minimum pitch angle is 15°.

For further information please contact our Sales or Technical Department.

## Small to Medium Span Pyramid

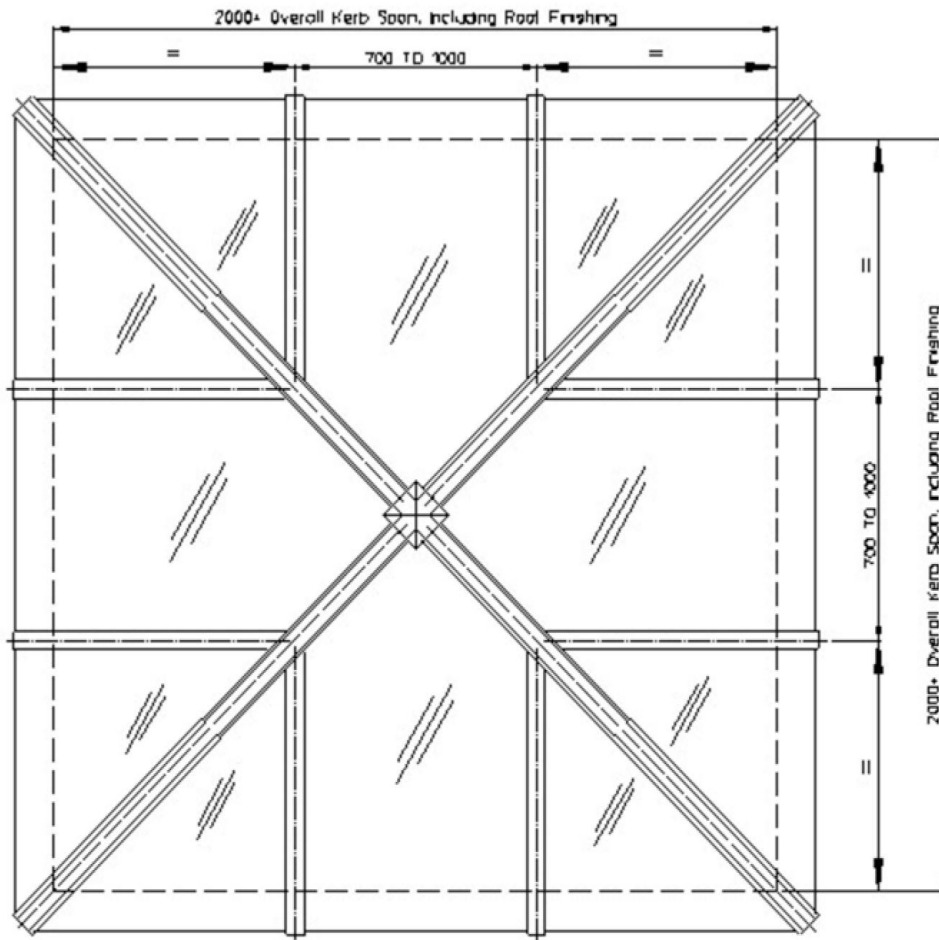

Plan View



Side Elevation View

## Small to Medium Span Pyramid

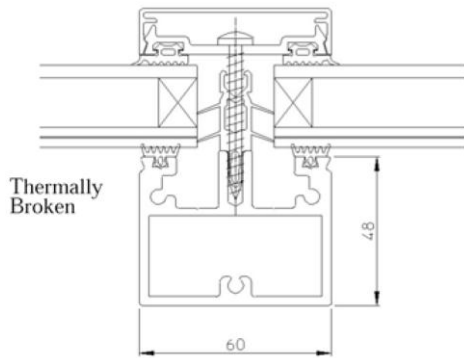

Jack Rafter Section View

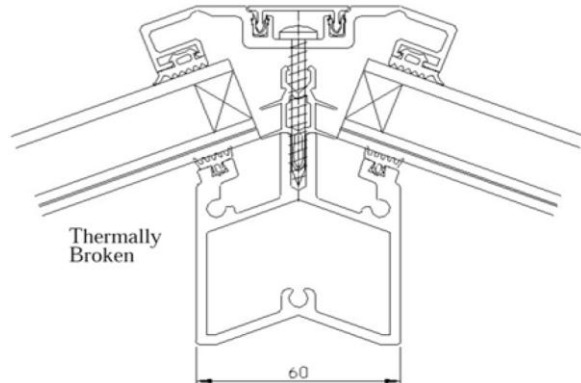

Hip Rafter Section View

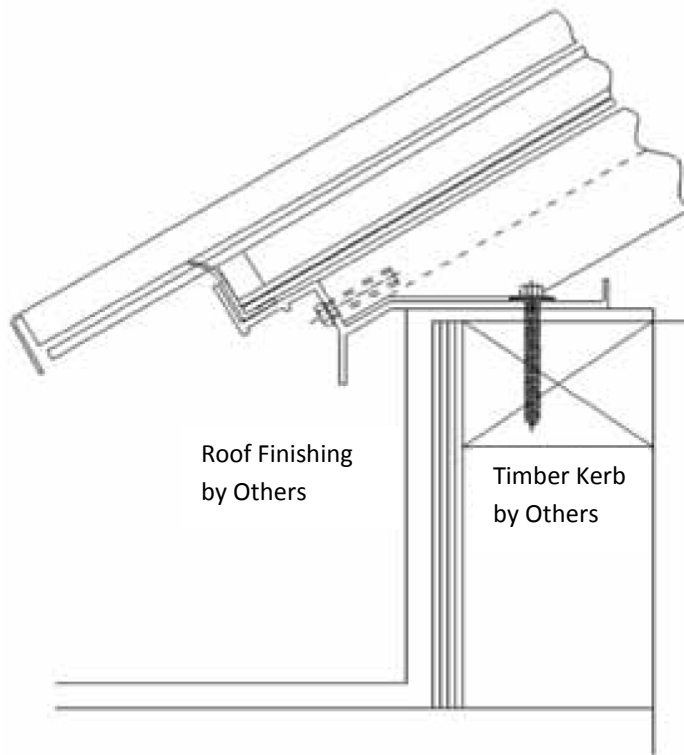

Kerb Section View

## Large Span Pyramid

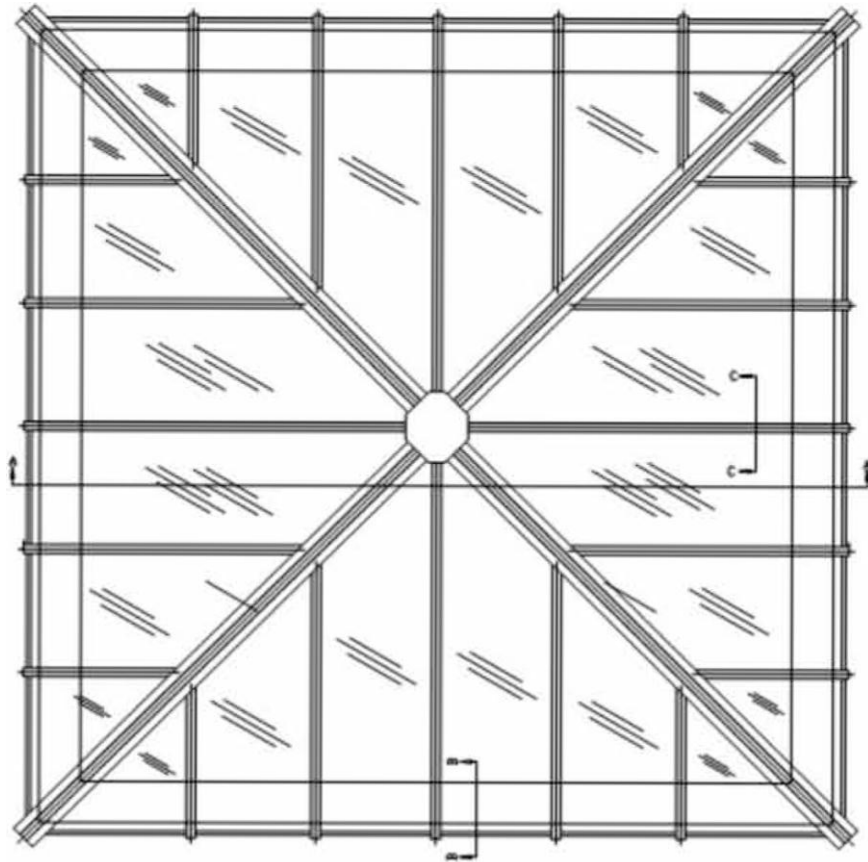

Plan View



Section A-A

## Large Span Pyramid

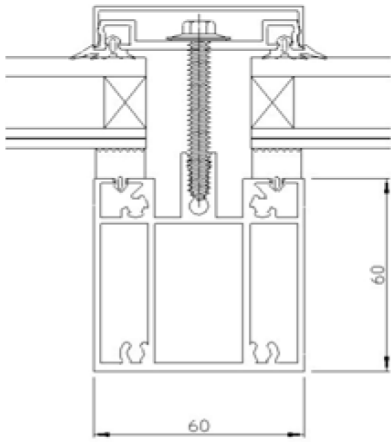

Rafter Section View

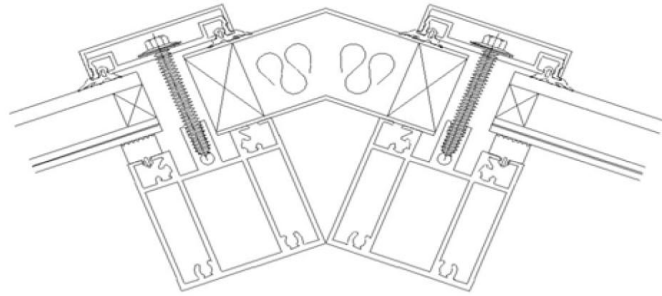

Hip Section View

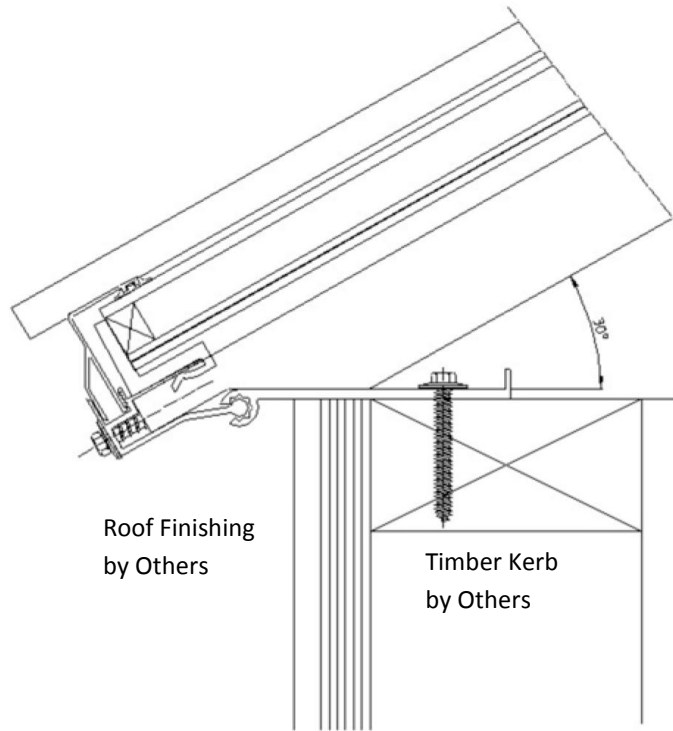

Kerb Section View

As our policy is one of continuous improvement, we reserve the right to change specifications without prior notice. All information, recommendations or advice (written or oral) given by Twinfix is given in good faith and to the best of our knowledge.

©June 2011