

## Glass Ridgelights



*The Twinfix range of high quality rooflights are designed to provide the maximum efficient distribution of natural light, together with a variety of ventilation options.*

- Building Regulation Part L compliant design to achieve low U value targets
- Non Fragile in accordance with ACR[M]001:2005 and CWCT TN67
- Ventilation options for Natural Ventilation in accordance with Building Regulation Part F
- Automatic opening vents for smoke ventilation

Twinfix self-supporting Ridgelights are available in Hip End or Gable End structures, designed to be installed to a weathered builder's kerb.

All Ridgelights are purpose made to suit variable overall kerb sizes, within a span range from 0.6m to 7m and of any length.

Twinfix Ridgelights are manufactured from mill finish or polyester powder coated aluminium extrusions and are glazed with hermetically sealed argon filled double glazed units as standard.

### Standard Glazing Options

Glazing	Glazing Options	U-Value	Light Transmission	G-Value
Outer: 4mm Toughened Cavity: 16mm Argon Inner: 6.4mm Laminated with soft Low-E coating	Clear	1.2 W/m <sup>2</sup> K	79%	0.70
	Self-Cleaning	1.2 W/m <sup>2</sup> K	76%	0.67
	Tinted Bronze	1.2 W/m <sup>2</sup> K	53%	0.51
Outer: 6mm Toughened Cavity: 16mm Argon Inner: 6.4mm Laminated with soft Low-E coating	Clear	1.2 W/m <sup>2</sup> K	78%	0.68
	Solar Control	1.1 W/m <sup>2</sup> K	67%	0.41
	Self-Cleaning	1.2 W/m <sup>2</sup> K	76%	0.65
	Tinted Bronze	1.2 W/m <sup>2</sup> K	43%	0.42
Other glazing options or specification are available on request				

### British Standards

Twinfix Ridgelights are designed to standard loadings of 640 N/m<sup>2</sup> (wind) and 750 N/m<sup>2</sup> (snow) and in accordance with the following British Standards:

- BS 6375 : Part 1 : Weather Tightness
- BS EN 1026 : Air Permeability
- BS EN 1027 : Water Tightness Test
- BS EN 12211 : Wind Resistance Test

### Pitch Options

Standard pitch angle is 30°.

Other pitch angles from 15° to 60° can be accommodated by bespoke design.

**Standard 30° Ridgelights with stepped edge glazing detail** are available for an overall kerb span range from 600mm to 3000mm.

**Bespoke variable pitch Ridgelights** are available for an overall span range of 600mm to 7000mm. Minimum pitch angle is 15°.

For further information please contact our Sales or Technical Department.

## Hip Ended Ridgelight

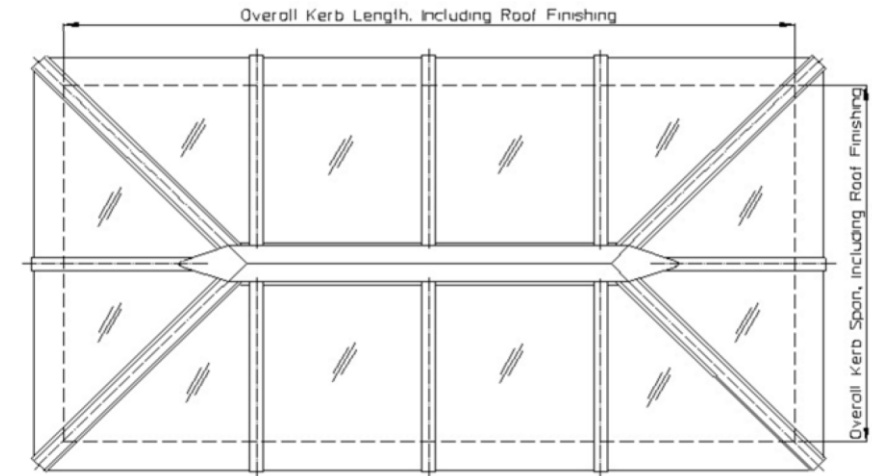

Plan View

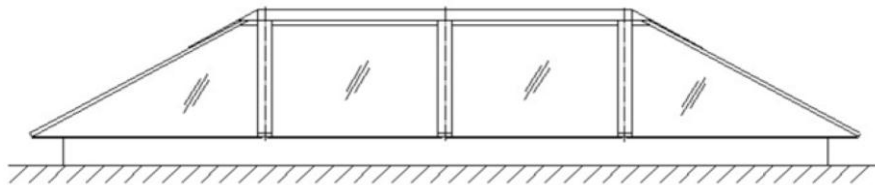

Side Elevation

## Gable Ended Ridgelight

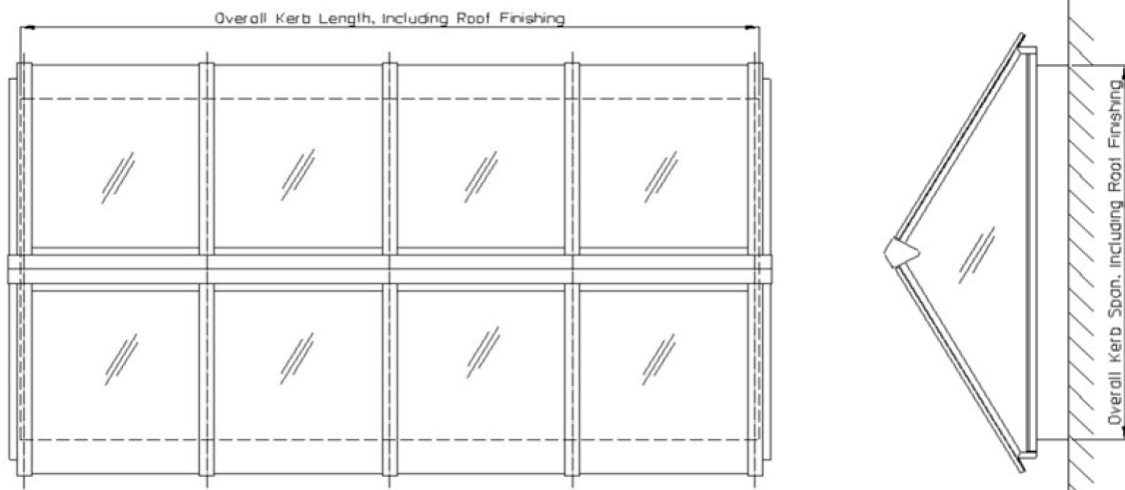

Plan View

End Elevation

## Hip Ended Ridgelight

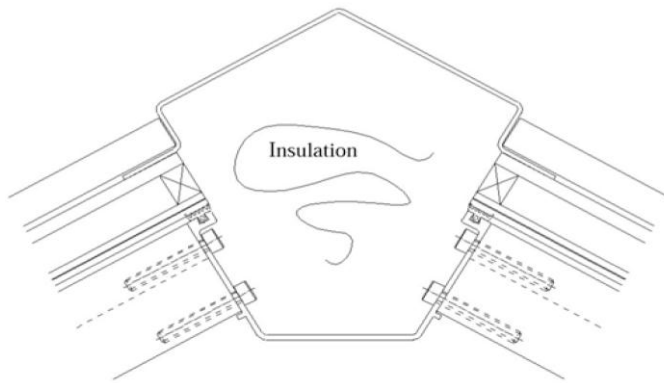

Ridge Section View

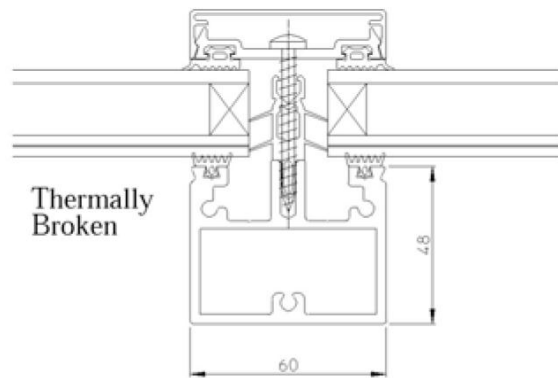

Rafter Section View

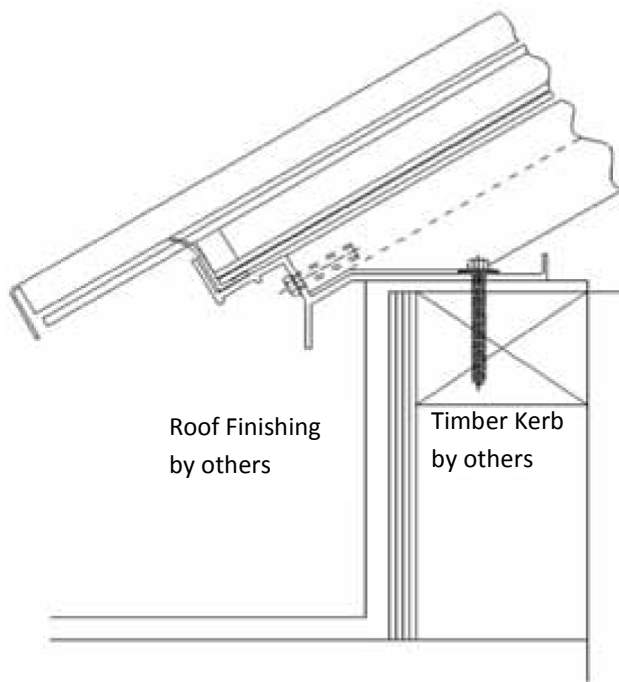

Kerb Section View

Top Hinged Opening Vent for natural ventilation and smoke evacuation

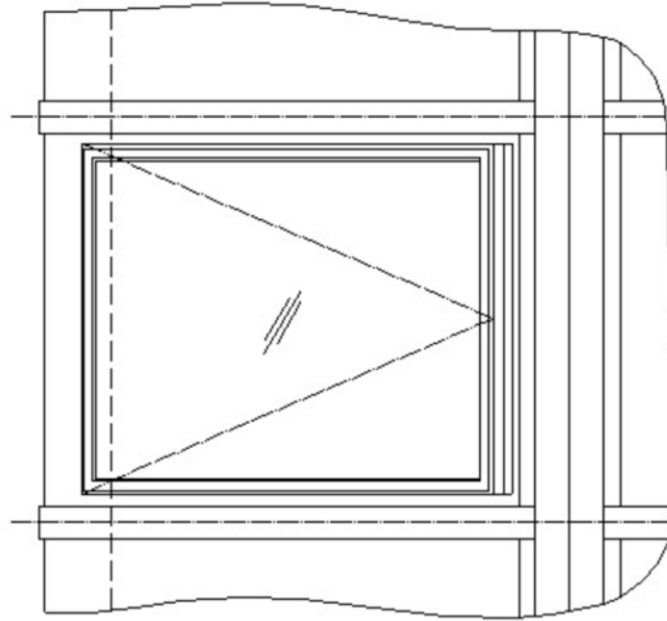

Part Plan View

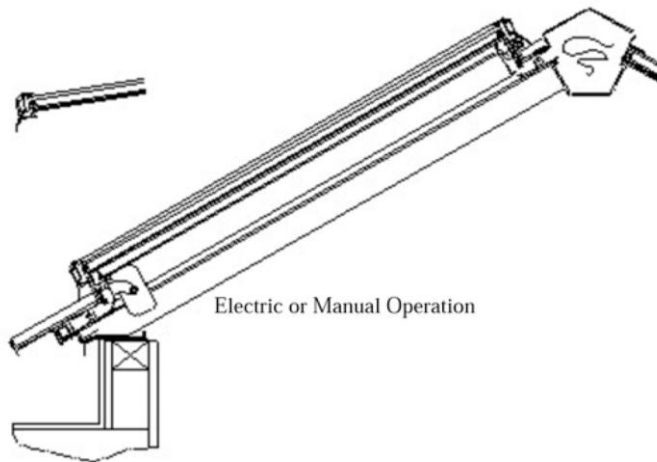

Part Section View

As our policy is one of continuous improvement, we reserve the right to change specifications without prior notice. All information, recommendations or advice (written or oral) given by Twinfix is given in good faith and to the best of our knowledge.

©June 2011